

- PENDANTS: one
- MOUNTING: mini copper canopy 60mm (2.4") in diameter x 6.5mm (0.25") deep
- LAMPING: 1.5w LED or 20w xenon
- CABLE: fixed lengths. 3000mm (10') standard / up to 9900mm (32') maximum
- MATERIALS: blown glass, flexible copper tubing, electrical components, copper hardware, white powder coated canopy
- WEIGHT: approximately 1.75kg (3.9lb)
- POWER SUPPLIES: remote mounted (fixture does not hook directly to a junction box). Power supplies included

DESCRIPTION

The 'mc' designation in this variation on the 28 refers to it being suspended by a mini canopy and flexible copper tubing. The surface light has a 6.5mm (0.25") deep by 60mm (2.4") in diameter copper mounting plate designed to be mounted on walls as well as ceilings.

28 is an exploration of specificity in manufacturing. Instead of designing form itself, here the intent was to design a system of making that yields form. Individual 28 pendants result from a complex glass blowing technique whereby air pressure is intermittently introduced into and then removed from a glass matrix which is intermittently heated and then rapidly cooled. The result is a distorted spherical shape with a composed collection of imploded inner shapes, one of which acts as a shade for the light source.

The 28 copper series provides a different compositional reading that results from shaping the copper tubing during installation. Pendants can be angled in any direction to provide a range of sculptural forms. The copper will weather and tarnish, registering the passage of time in its patina.

Standard 28s are made with clear glass exterior spheres and milk white interior lamp holder cavities. 28s are possible with infinite versatility in colour compositions, sizes and shapes.

NOTES

- + Purchase replacement lamps online at www.bocci.com/shop/bulbs
- + Unless otherwise noted when ordering, all fixtures will be outfitted to be xenon compatible
- + Preset lengths may have a variance of +/- 50mm (2")
- + Power supplies must be remote mounted

US Patent # D687,740
EU Patent # 001695834-001 to 004

Made in Vancouver, Canada

Vancouver
sales@bocci.com
www.bocci.com

Berlin
europe@bocci.com
www.bocci.com

approx 1.75kg (3.9lb)

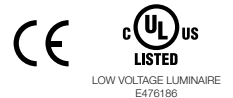

28.1mc

PRODUCT SPECIFICATION

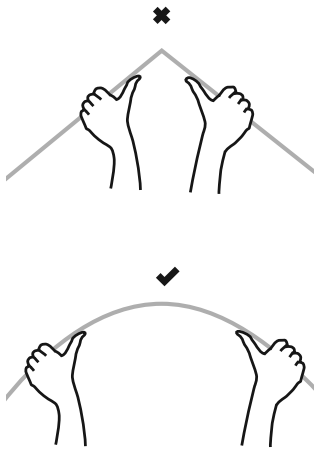

1

Separate the copper tubes according to length.

Very carefully uncoil the copper tube with both hands to avoid kinking.

Note: be very careful not to overbend the copper tubes as it will leave a permanent kink that can not be removed.

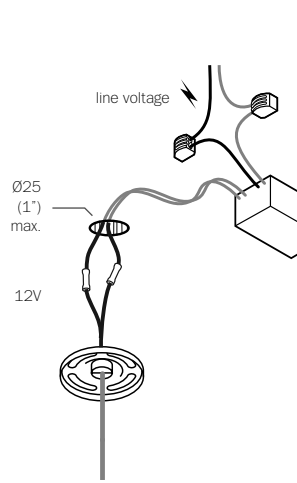

2

Mount power supply remotely. Drill a 25mm (1") diameter hole in ceiling material. Route output wiring from power supply to fixture location. Pull low voltage house wire through the hole

Join power supply wiring to mini canopy wiring using #16 butt splices (stagger the splices). Use raw butt splices and heat shrink to simplify the installation. Connect the power supply leads to line voltage.

Xenon/LED:

Connect the coaxial cable to the open slots in the terminal block on the 12V side of the power supply. Ensure that the braided outer wires are all connected to one 12V output wire and all inner insulated wires are connected to the other or a short will occur.

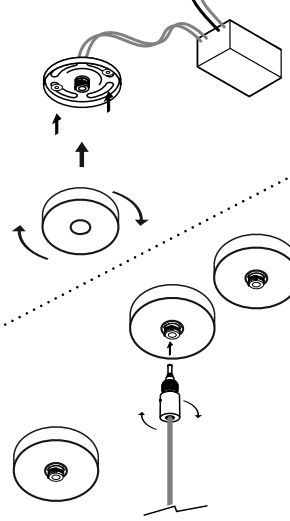

3

Affix mini-canopy to surface with fasteners provided. Twist the threaded canopy cover plate into place.

Thread the male headphone jack connection end of the copper length onto the female jack-connection in the center of the canopy.

Repeat this step for all canopies in your installation.

4

Compose the copper tubing according to the intended design aesthetic.

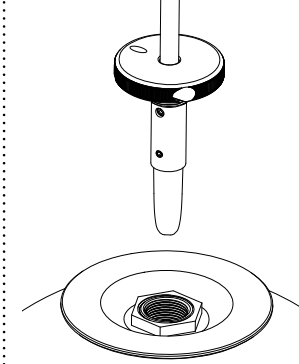

5

Plug the lamp into the socket. Check that each lamp is working properly as you go along by keeping power on.

Thread the pendant on.

Note: Once the pendant is added, it will pull the copper downwards. The pendant will try to hang directly below the canopy as the copper is not rigid enough for long horizontal compositions without the addition of swag hooks.

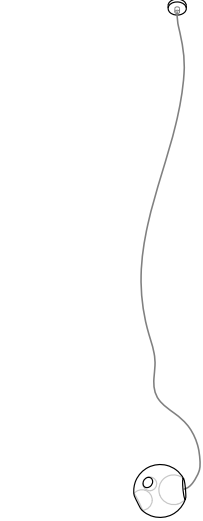

6

Clean fingerprints from surfaces.

For additional assistance, please contact Bocci:

Vancouver
sales@bocci.com
www.bocci.com

Berlin
europe@bocci.com
www.bocci.com

US Patent # D687,740
EU Patent # 001695834-001 to 004

Made in Vancouver, Canada



28.1mc

PRODUCT INSTALLATION INSTRUCTIONS

© 2021, Bocci Design and Manufacturing Inc. All rights reserved. Any inquiries should be directed to: info@bocci.com

BOCCI